

MAXIMUM TORQUE NOT TO EXCEED 40,000 FT-LBS

ULTIMATE CAPACITY OF 180 KIPS BASED ON CAPACITY TO TORQUE RATIO OF $K_t = 4.5 \text{ FT}^{-1}$

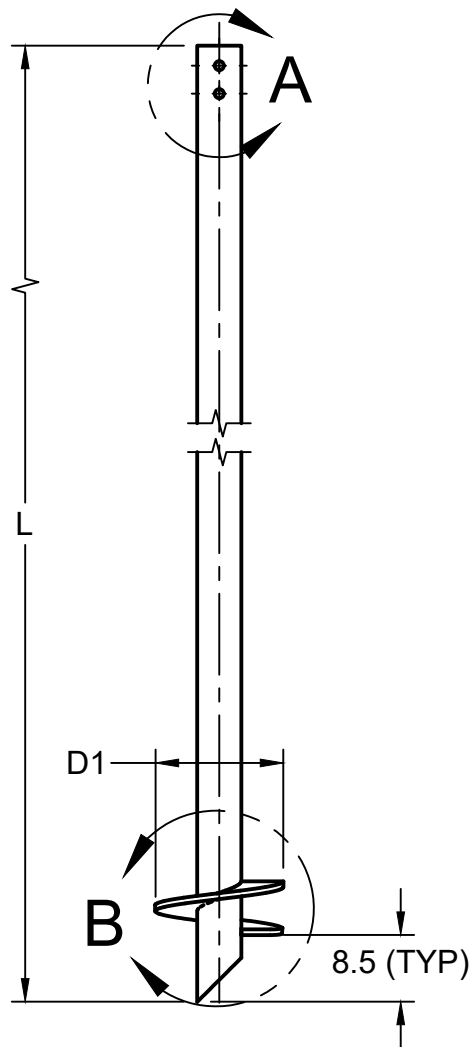

SINGLE HELIX (SH) LEAD
EX: (512361SH[L][D1]X[T]G)

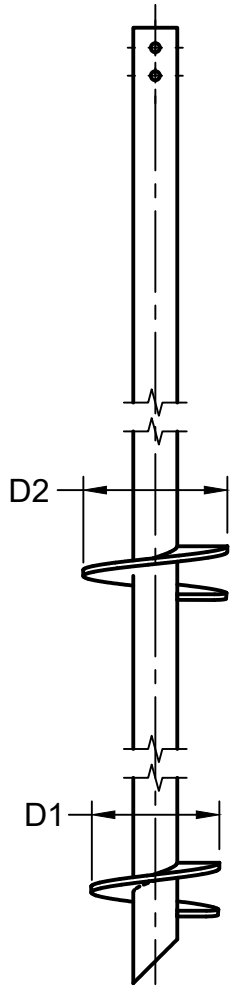

DOUBLE HELIX (DH) LEAD
EX: (512361DH[L][D1,D2]X[T]G)

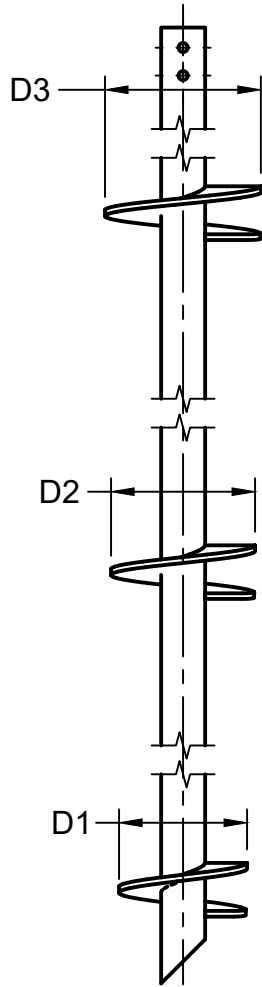

TRIPLE HELIX (TH) LEAD
EX: (512361TH[L][D1,D2,D3]X[T]G)

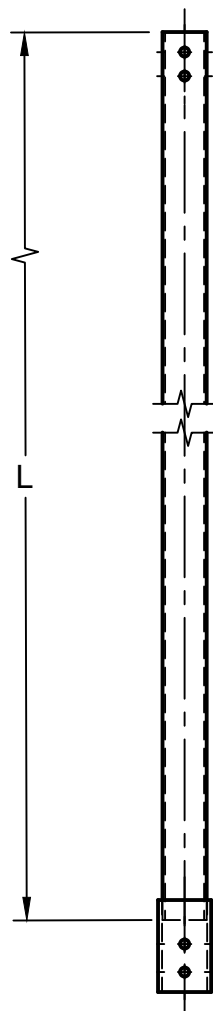

EXTENSION
EX: (512361EXT[L]G)

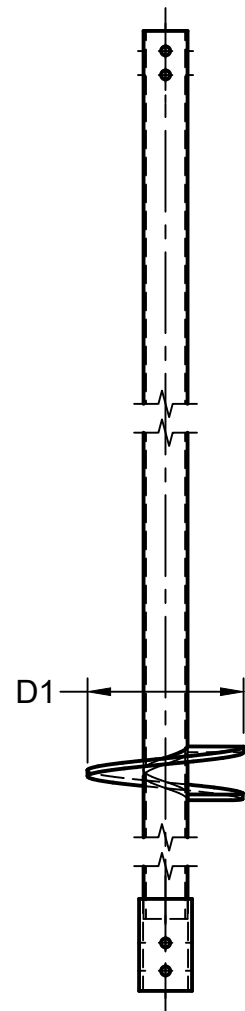

SINGLE HELIX (SH) EXTENSION
EX: (512361FESH[L][D1]X[T]G)

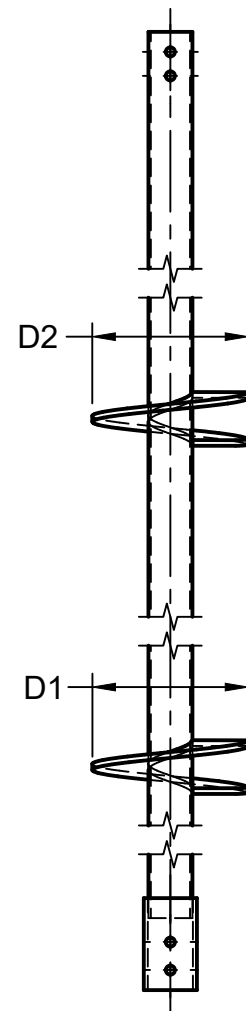

DOUBLE HELIX (DH) EXTENSION
EX: (512361FEDH[L][D1,D2]X[T]G)

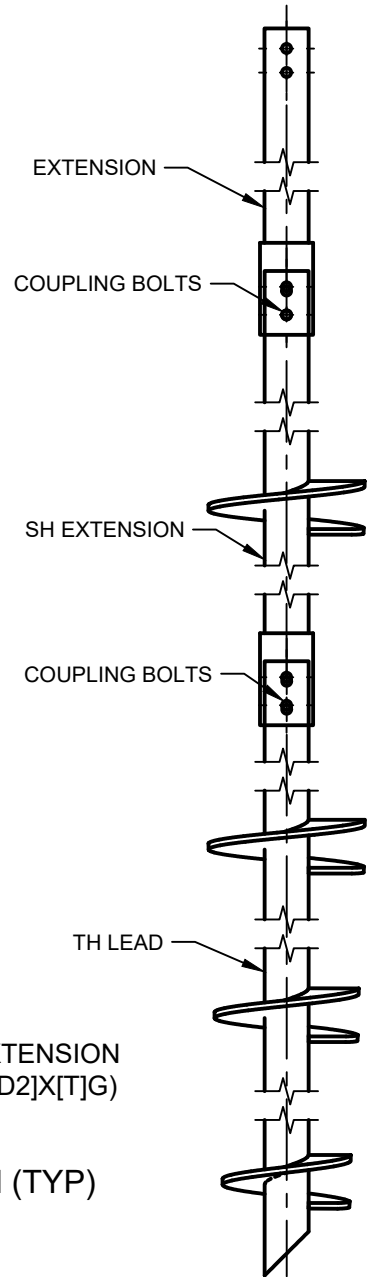

TYPICAL PILE ASSEMBLY

NOTES:

- PILE SHAFT TO MEET OR EXCEED 80 KSI
- PLATE STEEL TO MEET OR EXCEED REQUIREMENTS OF A572 GRADE 50
- ALL HELICES ARE FORMED BY PRESS DIE
- HELIX SPACING IS EQUAL TO (3) TIMES THE DIAMETER OF THE LOWER HELIX
- STANDARD HELIX DIAMETERS INCLUDE 12", 14", 16", 18" & 20". 3/4" THICKNESS.
- ALL WELDING TO BE PERFORMED BY CERTIFIED WELDER IN ACCORDANCE WITH CWB W59-18
- BARE STEEL IS STANDARD. HOT DIP GALVANIZING AS PER CAN/CSA G 164 or ASTM 123
- (2) 1" DIAMETER X 8 1/2" LONG HEAVY HEX BOLTS AND 1" HEAVY HEX NUT

NORTEK PART# ABBREVIATIONS

512 = SHAFT DIAMETER
361 = SHAFT WALL THICKNESS
L = SHAFT LENGTH IN FT
EXT = EXTENSION
FE = FLIGHTED EXTENSION
D = DIAMETER OF HELIX (EX. 12" = 12)
SH = SINGLE HELIX
DH = DOUBLE HELIX
TH = TRIPLE HELIX
X = SEPARATES HELIX DIAMETERS AND THICKNESSES
[T] = HELIX THICKNESS
G = GALVANIZED

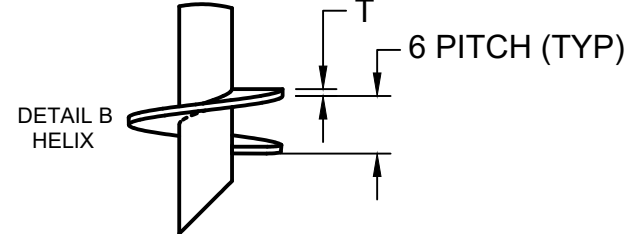
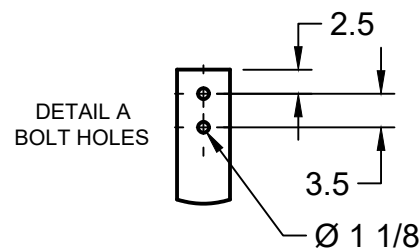

5.5" x 0.361" W.T HELICAL LEADS & EXTENSIONS



PROPRIETARY AND CONFIDENTIAL
THE INFORMATION CONTAINED IN THIS DRAWING IS THE SOLE PROPERTY OF NORTEK HELICAL PILES. ANY REPRODUCTION IN PART OR AS A WHOLE WITHOUT WRITTEN PERMISSION OF NORTEK HELICAL PILES IS PROHIBITED.

APPROVED	K.D	2024-02-02	NORTEK HELICAL PILES 1098 INDUSTRIAL RD AYR, ON N0B 1E0 519-623-3858 WWW.NORTEKHELICALPILES.CA
CHECKED	C.D	2024-01-20	
DRAWN	K.D	2024-01-04	
DWG NO	1		

SHEET 1 OF 1

UNITS IN INCHES U.N.O

REV 01